



OPTION: Extension, suitable for transport of long loads.

ErgoMover Lift & Go

ErgoMover Lift & Go is an electric battery powered transport trolley with hydraulic lift of the flat bed. The trolley is developed to replace the manual plasterboard trolleys by assisting in manual heavy lifting tasks and optimising the handling of plasterboards and other building materials.

LARGE CAPACITY

The trolley has a powerful electric motor and 4-wheel steering and is suitable for driving off-road and on construction sites.

The ErgoMover Lift & Go is able to lift the flat bed by 150mm which makes it ideal, for example, for placing plasterboards on trestles. It can transport and lift an impressive 1.500 kg.



ErgoMover Lift & Go 360°

- with hydraulic lift and 360° rotatable table. Suitable for areas with limited space.



OPTION: Extension, suitable for transport of long loads.

SPECIFICATIONS*

Lifting capacity:	1.500 kg
Length, table:	1.620 mm
Width, table:	698 mm
Total width:	701 mm
Total length w. handle down:	3.021 mm
Total length Wireless:	1.702 mm
Height, Min / Max:	595 / 791 mm
Weight, w. drawbar:	331 kg
Weight, Wireless	404 kg
Turning radius:	~ 3,5 m
Voltage:	24 Volt
Speed:	0-6 km/h

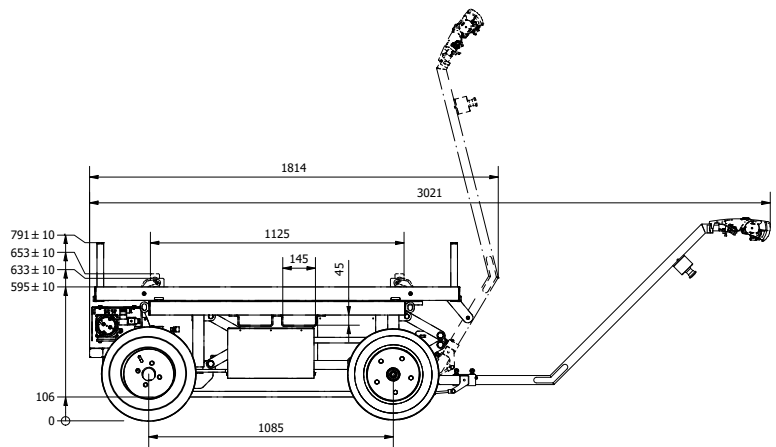

! Min. trestle height: 700 mm.

Wireless (with remote control)

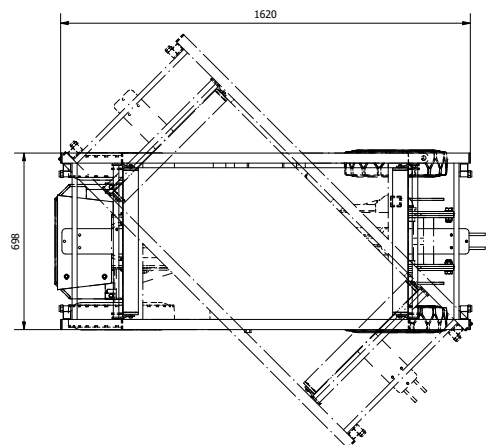
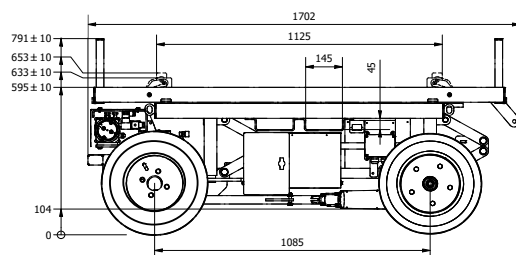
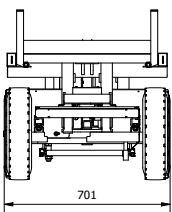

*The dimensions are indicative and may vary +/- 10mm